

PREPARED BY:  
 AERIAL SURVEY AND PHOTO, INC.  
 546 AIRPORT ROAD, P.O. BOX 659  
 NORRIDGEWOCK, MAINE 04957  
 TEL: 207 634-2006 FAX 207 634-2008

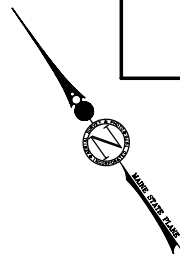

**NOTES:**

- 1) THIS MAP IS FOR ASSESSMENT PURPOSES ONLY AND IS NOT INTENDED FOR PROPERTY CONVEYANCE OR LEGAL DESCRIPTION.
- 2) P = PARCEL INFORMATION FROM RECORDED PLAN  
 D = PARCEL INFORMATION FROM RECORDED DEED  
 S = PARCEL INFORMATION FROM MAP SCALE ONLY

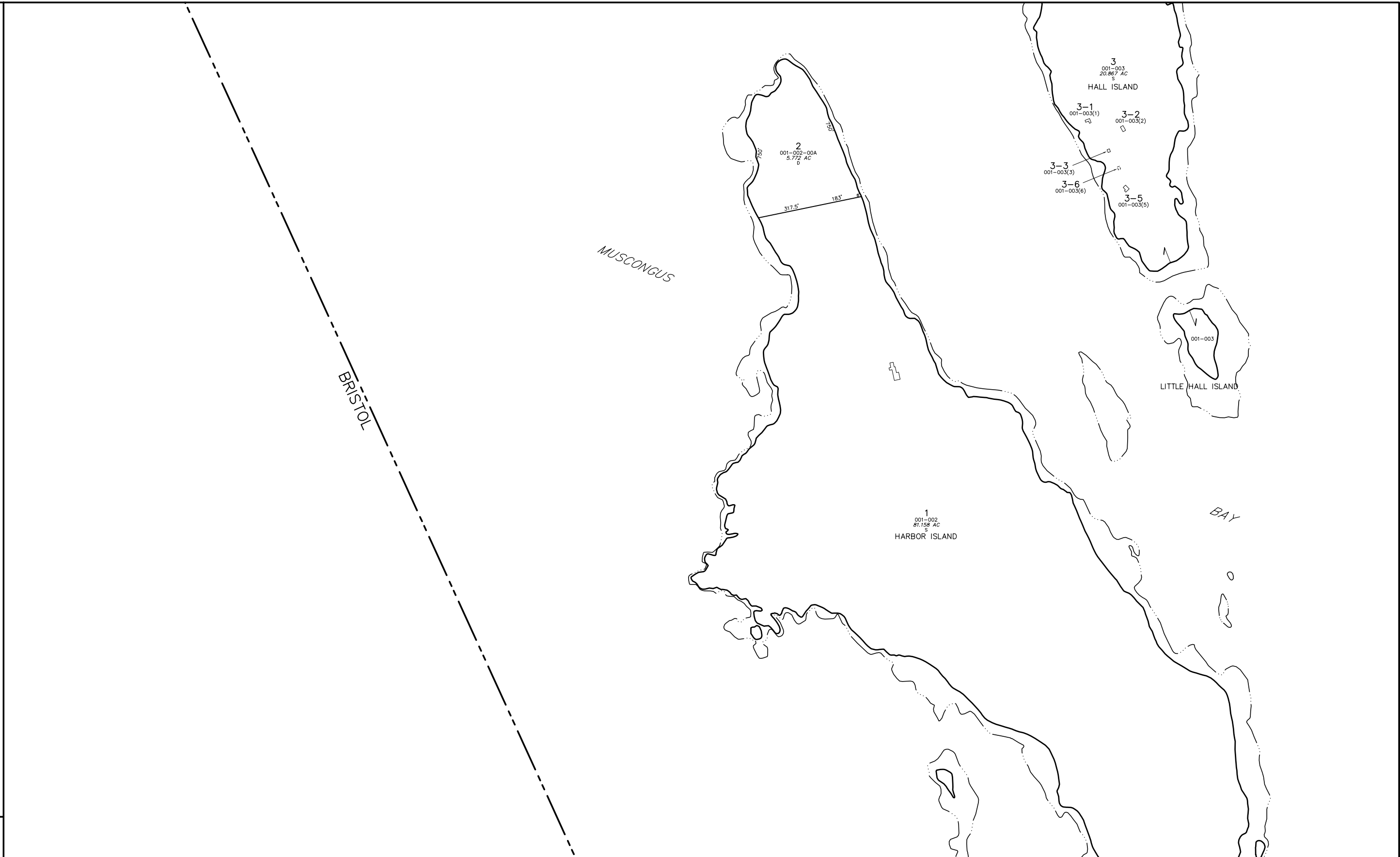
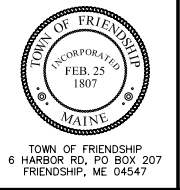

PARCEL NUMBER ..... **23**  
 PARCEL DIMENSION ..... 161.21'  
 PARCEL AREA ..... 2.456 AC  
 MATCH LABEL ..... P/O MAP 136 LOT 23  
 BUILDING FOOTPRINT .....   
 SUBDIVISION LOT NUMBER .....   
 OLD MAP—LOT NUMBER ..... 013-007-00C  
 APPROXIMATE MEAN HIGH WATER LINE

**MAP LEGEND**

PARCEL BOUNDARY.....	
WATER LINE .....	
ROAD RIGHT OF WAY....	
PAPER STREET .....	
EASEMENT LINE .....	
PRIVATE RIGHT OF WAY .....	
WETLAND EDGE .....	

APRIL 1, 2011

SCALE 1 INCH = 200 FEET

MAINE STATE PLANE COORDINATE GRID; EAST ZONE; NAD 1983; US FEET  
 PHOTOGRAPHY DATE: APRIL 30, 2003  
 PHOTOGRAMMETRIC COMPILATION BY AERIAL SURVEY AND PHOTO, INC.  
 PARCEL MAP COMPILATION BY AERIAL SURVEY AND PHOTO, INC.

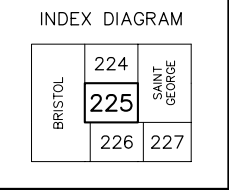

PROPERTY MAP  
 TOWN OF FRIENDSHIP  
 KNOX COUNTY, MAINE

**225**